

**Feature**

SAM Series are power line relays allowing 60 to 1600 Amps. switching power, with Voltage ratings upto 660Volts A.C. SAM series is Dual SCR Power Hybrid technology provides highly efficient thermal management for greatly increased cyclic life.

- ▲ High performance/low cost circuit design.
- ▲ Logic compatible current regulated input.
- ▲ 2500 Vrms optical isolation.
- ▲ Both “Zero Voltage” & phase controllable “Random Switching” versions.
- ▲ LED-indication for control input.
- ▲ Control voltage range: 3 to 32Vdc or 90~280Vac

**Solid State Relay Ordering Guide**

**S A M 40 200 D R**

JEENDA SSR model Number

**A** = ACSSR

**M**=module type solid state relay

Load Voltage: 40 = 40-480VAC ; 66= 90-660VAC;

Max Current:60A, 80A, 100A, 120A,150A,200A,250A,300A,400A,500A,600A,800A,1000A,1600A;

**D**=3-32VDC input ,**A**=90-280VAC input.

**NIL**=Zero voltage turn on, **R**= Random turn on.

**Specifications**

Input Parameter	D	A
Control Voltage Range	3 to 32Vdc	90 to 280Vac
Input Current (Max.)	13/16 mA <sub>dc</sub> @=5V/12V	29 mA <sub>ac</sub> @=220V
Must Turn On Voltage	3Vdc	90Vac
Must Turn Off Voltage	1Vdc	10Vdc
Reverse Voltage (Max.)	32Vdc	/
Display LED	Yes	Yes

Output Parameter	Units	Specification Limits			
Model No. <b>SAM</b>		80A	100A	120A	150A
Load Current Range	Arms	0.05 to 80	0.05 to 100	0.05 to 200	0.05 to 150
Surge Current, 20 mSec (Max.)	Arms	200	260	300	400
Load Voltage Range (480V)	Vrms	40 to 480			
SCR Over voltage (480V)	Vpk	1200			
Load Voltage Range (660V)	Vrms	90 to 660			
SCR Over voltage (660V)	Vpk	1600			
Frequency Range	Hz	47 to 63			
Min. Off-state dv/dt	V/μsec	500			
Off State Leakage Current (Max.)	mArms	8			
On-State Voltage Drop (Max.)	Vrms	1.6			
Thermal Resistance, (R <sub>thjc</sub> )	°C / W	0.65	0.3	0.3	0.3
Turn On Time (Max.) “Z”	Cycle	1/2			
Turn On Time (Max.) “R”	mSec	1			
Turn Off Time (Max.)	Cycle	1/2			

Output Parameter	Units	Specification Limits			
		200	250	300	350
Model No. <b>S A M</b>		200	250	300	350
Load Current Range	Arms	0.05 to 200	0.05 to 250	0.05 to 300	0.05 to 350
Surge Current, 20 mSec (Max.)	Arms	2500	3400	4500	5000
Load Voltage Range (480V)	Vrms	40 to 480			
SCR Over voltage (480V)	Vpk	1200			
Load Voltage Range (660V)	Vrms	90 to 660			
SCR Over voltage (660V)	Vpk	1600			
Frequency Range	Hz	47 to 63			
Off State dv/dt (Min)	V/μsec	500			
Off State Leakage Current (Max.)	mArms	10			
On State Voltage Drop (Max.)	Vrms	1.8			
Thermal Resistance, (Rthjc)	°C / W	0.22	0.15	0.14	0.13
Turn On Time (Max.) "Z"	Cycle	1/2			
Turn On Time (Max.) "R"	mSec	1			
Turn Off Time (Max.)	Cycle	1/2			
Turn Off Time (Max.) "A2"	mSec	40			

Output Parameter	Units	Specification Limits			
		400A	500A	600A	800A
Model No. <b>SAM</b>		400A	500A	600A	800A
Load Current Range	Arms	0.05 to 400	0.05 to 500	0.05 to 600	0.05 to 800
Surge Current, 20 mSec (Max.)	Arms	6000	7200	8200	9600
Load Voltage Range (480V)	Vrms	40 to 480			
SCR Over voltage (480V)	Vpk	1200			
Load Voltage Range (660V)	Vrms	90 to 660			
SCR Over voltage (660V)	Vpk	1600			
Frequency Range	Hz	47 to 63			
Min. Off-state dv/dt	V/μsec	500			
Off State Leakage Current (Max.)	mArms	10			
On-State Voltage Drop (Max.)	Vrms	1/2			
Thermal Resistance, (Rthjc)	°C / W	0.12	0.12	0.1	0.1
Turn On Time (Max.) "Z"	Cycle	1/2			
Turn On Time (Max.) "R"	mSec	1			
Turn Off Time (Max.)	Cycle	1/2			
Turn Off Time (Max.) "A2"	mSec	40			

Output Parameter	Units	Specification Limits	
		1000A	1600A
Model No. <b>SAM</b>		1000A	1600A
Load Current Range	Arms	0.05 to 1000	0.05 to 1600
Surge Current, 20 mSec (Max.)	Arms	12500	22000
Load Voltage Range	Vrms	90 to 660	
SCR Over Voltage	Vpk	1600	
Frequency Range	Hz	47 to 63	
Min. Off-state dv/dt	V/μsec	500	
Off State Leakage Current (Max.)	mArms	35	35
On-State Voltage Drop (Max.)	Vrms	1.8	
Thermal Resistance, (Rthjc)	°C /W	0.07	0.06
Turn On Time (Max.)	Cycle	1/2	
Turn Off Time (Max.)	Cycle	1/2	
<b>Coupling Specifications</b>			
Dielectric (Input/Output)	Vrms	2500	
Dielectric (Input-Output/Base)	Vrms	2500	
Capacitance	pf	10	
<b>General Specifications</b>			
Ambient temperature range:	operating or Storage	-30 to +80 °C	
Base plate: Copper, nickel-plated			
Case Color: Black			

Case and Dimension

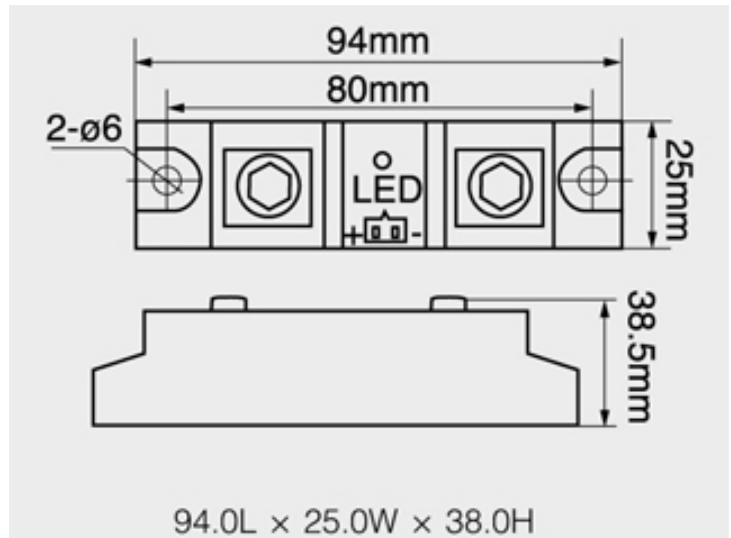

**Weight: ( typical) 125g,Case A for 80-120A**

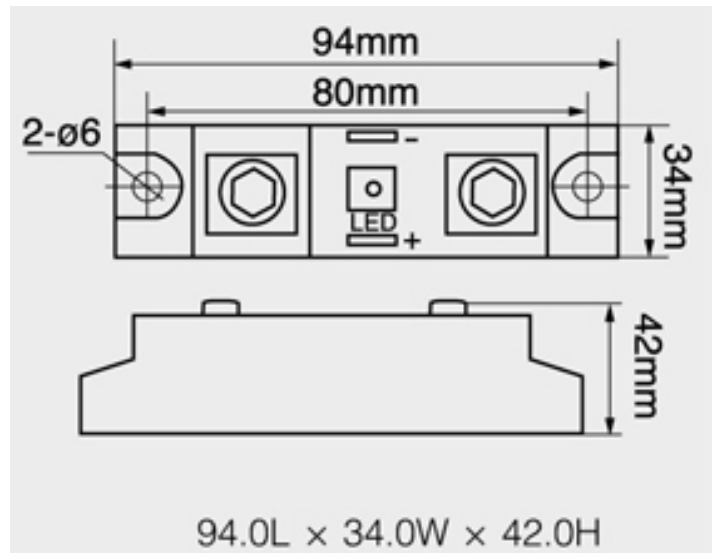

**Weight: ( typical) 280g,Case B for 150-350A**

**Case and Dimension**

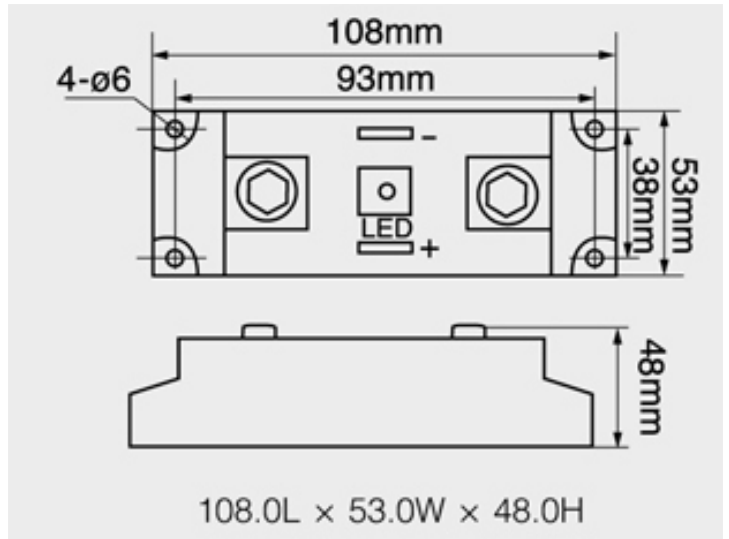

**Weight: ( typical) 500g, Case C for 400A**

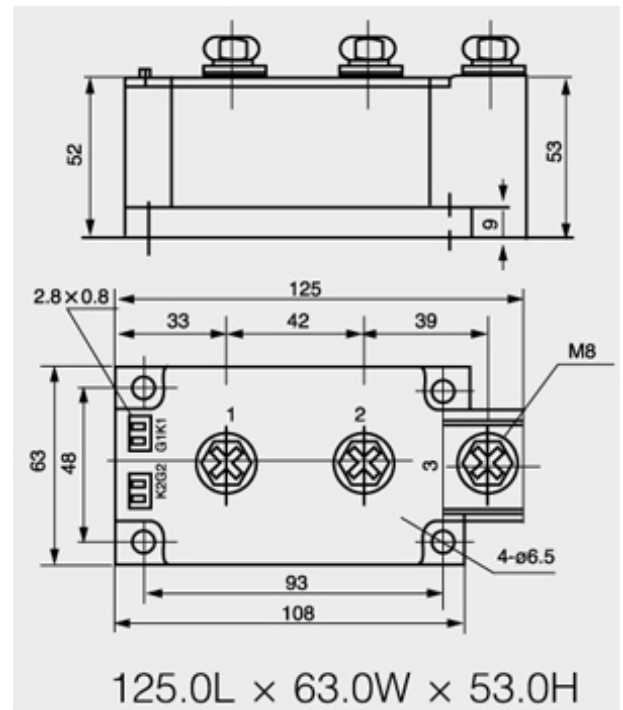

**Weight: ( typical) 1400g, Case D for 500-600A**

Case and Dimension

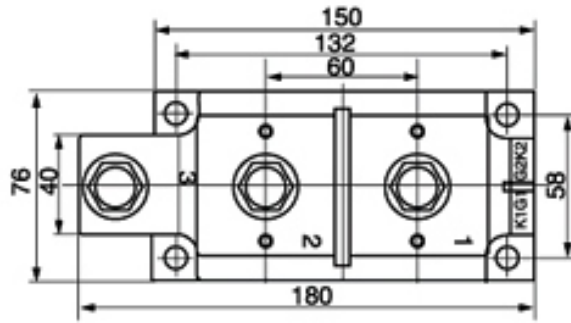
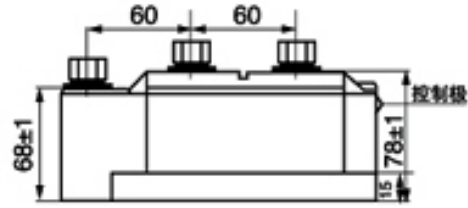

180.0L × 76.0W × 68.0H

**Weight: ( typical) 1600g, Case E for 800A,1000A,1600A.**